

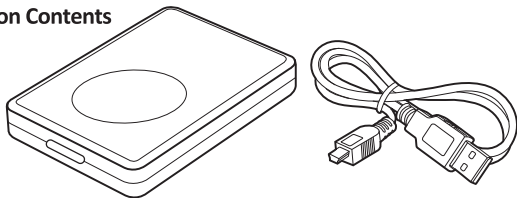

# *ACTION REPLAY* **PowerSaves™** for Amiibo™

## Carton Contents



## Installing the PowerSaves Amiibo™ PC software

1. Go to the webpage: [www.codejunkies.com/PowerSaves-for-amiibo/](http://www.codejunkies.com/PowerSaves-for-amiibo/)
2. Select the PowerSaves Amiibo™ software option beneath the download section to download the software to a location of your choice.
3. Right click on the downloaded compressed file and select 'Extract All'.
4. Select 'Extract' to uncompress the files to the same location as the compressed file.
5. Double click the setup file stored within the uncompressed folder to begin the software installation.
6. Follow the on-screen prompts to install the software to a location of your choice.

## Connecting the PowerSaves Amiibo™ Portal to your PC

Insert the smaller end of the USB cable into the PowerSaves Amiibo™ portal ensuring that the USB connector is correctly orientated. Insert the larger end of the USB cable into a free USB connection on your PC.

Following the connection of the USB cable your PC will automatically install the generic drivers required to use the PowerSaves Amiibo™ portal with the PowerSaves Amiibo™ PC software.

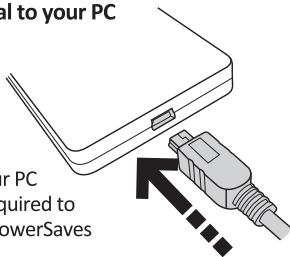

## Applying Codes to your Amiibo Character

A wide array of codes are available to boost your Amiibo character's abilities and statistics giving you the ultimate edge. In order to use codes with your Amiibo character please follow these steps:

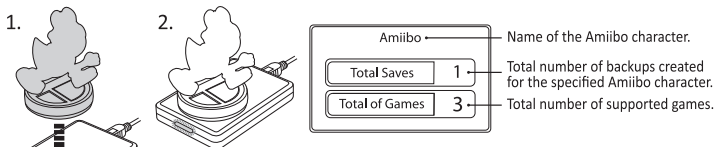

The character name is displayed if the character is recognised and only content for the supported games will be accessible. If the character is not recognised 'Amiibo' is displayed instead of the character name and all game content is accessible. Select the tick button to proceed to the next step.

### 3. Select the Apply Cheat button.

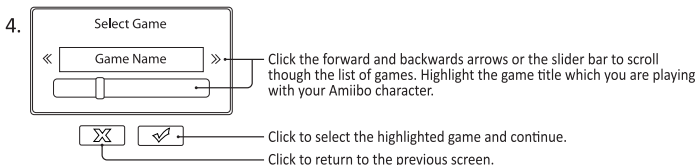

**Resetting your Amiibo** In order to prepare your Amiibo character for use with a different game, create a backup of your character data as detailed under the section 'Back up your Amiibo Character' and scroll to the game title 'Reset Game Data'. Use the tick button to apply the reset and confirm that you wish to do so.

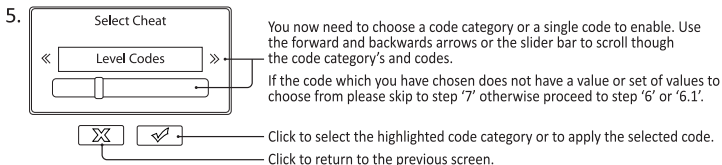

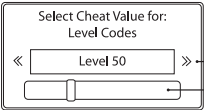
6.  Having chosen a code category you can now select the code value (For example Level 50 or 1000 Cash). Use the forward and backwards arrows or the slider bar to scroll through the code values.
- Click to apply the chosen code value.
- Click to return to the previous screen.

For certain code categories you may need to repeat the same step several times for each of the code values required.

- 6.1. Some code values are displayed as part of a list and are displayed as follows:

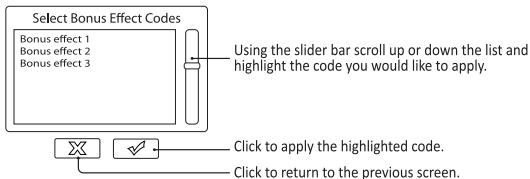

7. You are now asked to confirm that you would like to apply the chosen codes to your Amiibo Character. Select the 'Yes' button to continue or the 'No' button to return to the previous screen.

The process may take a brief period to complete so please ensure that your Amiibo character is not removed until the process has completed.

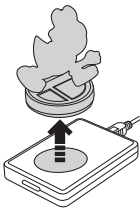
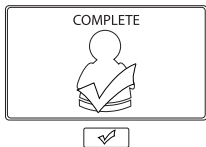

## Back up your Amiibo Character

The backup feature enables you to create a backup of your Amiibo character data which you can restore at any time. The backup feature is particularly useful to allow you to reset your Amiibo character for use with a different game but without losing your Amiibo character data for the game you have previously been playing. We would recommend creating a backup of your Amiibo character data before applying codes to allow you to easily restore your current Amiibo character status if you choose to do so.

In order to create a backup of your Amiibo character please follow these steps:

- 1.
2. Select the tick button and proceed to the next step.

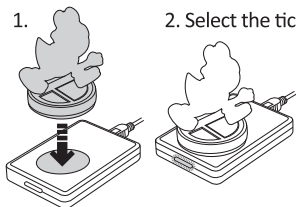

Amiibo	
Total Saves	1
Total of Games	3

Name of the Amiibo character.

Total number of backups created for the specified Amiibo character.

Total number of supported games.

3. Select the Backup button.

4.

Name & Confirm

Backup

Enter save description

Enter a description for the backup you are creating to allow you to easily identify each backup. You may choose to enter the time and date, as well as the game you are playing.

☒

☐

Click to return to the previous screen.

Click to create your backup.

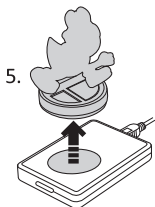

- 5.

## Restore your Amiibo Character

In order to restore your backup data please follow these steps:

- 1.
2. Select the tick button and proceed to the next step.

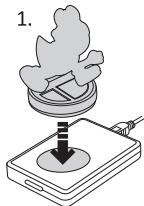

Amiibo	
Total Saves	1
Total of Games	3

Name of the Amiibo character.

Total number of backups created for the specified Amiibo character.

Total number of supported games.

3. Select the Restore button.

Select Bonus Effect Codes
Bonus effect 1
Bonus effect 2
Bonus effect 3

Using the slider bar scroll up or down the list and highlight the backup data you would like to restore.



Click to return to the previous screen.

Click to restore the highlighted backup.

- 5.

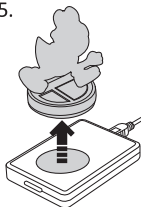

## Technical Support

Before contacting Datel's customer service department, please ensure that you have read through and understood the information in this user guide. Please ensure that you have information on when and where you purchased this product to hand.

Datel Customer Services Europe  
Customers Services, Datel Ltd  
Stafford Road, Stone, STAFFS. ST15 0DG  
UNITED KINGDOM  
Email: [support@datel.co.uk](mailto:support@datel.co.uk)  
Web: <http://uk.codejunkies.com/support>



© 2015 Datel Ltd. PowerSaves is a trademark of Datel Ltd. Amiibo is a trademark or registered trademark of NINTENDO in the United States and/or other countries. All other trademarks are the property of their respective owners. PowerSaves for Amiibo is a 100% unofficial product and is NOT sponsored, endorsed or approved by NINTENDO, nor any games developer or publisher.